 BAU Bahçeşehir University	BAUPASS INSTALLATION AND USER GUIDE		Page Number	1 / 2
	Document Number	BAU-BİDB-KL-014	Revise Numver	-
BAHÇEŞEHİR UNIVERSITY	Publish Date	12.09.2024	Revise Date	-

BAU Pass Installation and User Guide for Android Devices

Find and download the application by typing the link [Android](#) in the browser of your Android brand mobile phones and then press the 'Open' button. Then press the 'Get/Reset Password' button. Then enter your e-mail address or mobile phone number on the 'Account verification' screen and press the 'Send' button.

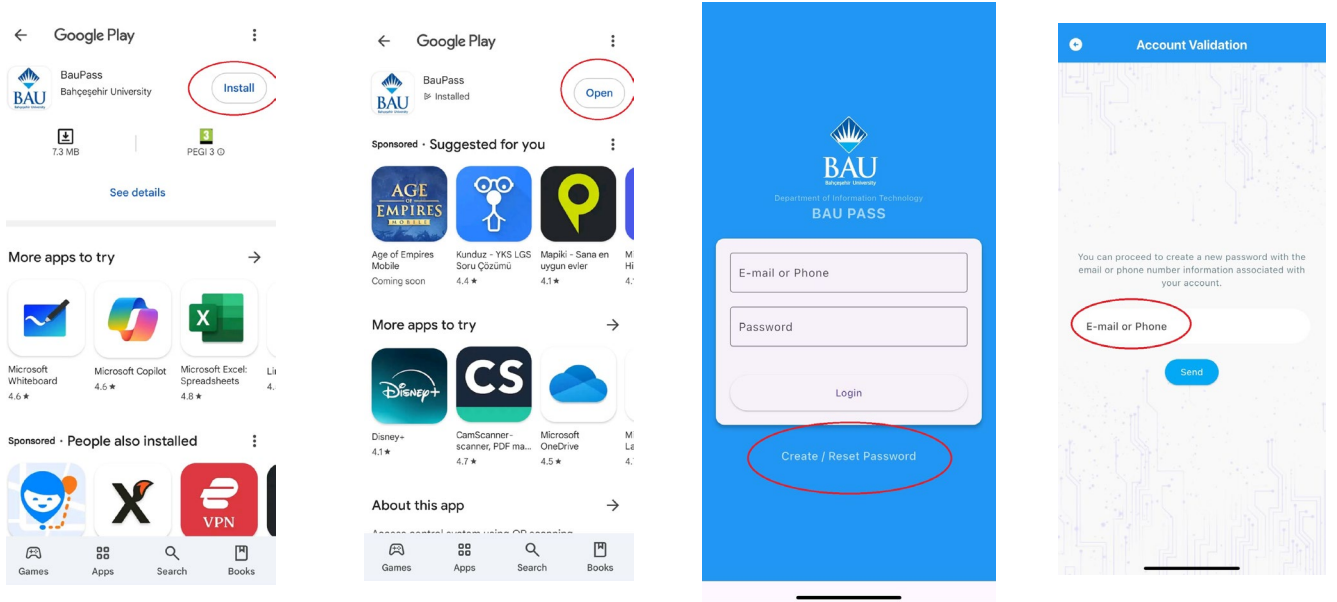

Capture 1

Capture 2

Capture 3

Capture 4

Enter the 6-digit verification code sent to you in the digits on the 'Activation Code' screen. Then enter your own password on the 'Password Reset' screen and press the 'Send' button. Then press the 'Continue' button on the screen with the confirmation sign. Afterwards, when the 'Activation' screen comes up, you will activate your device by pressing the button marked '+' and your BAU PASS profile will be opened..

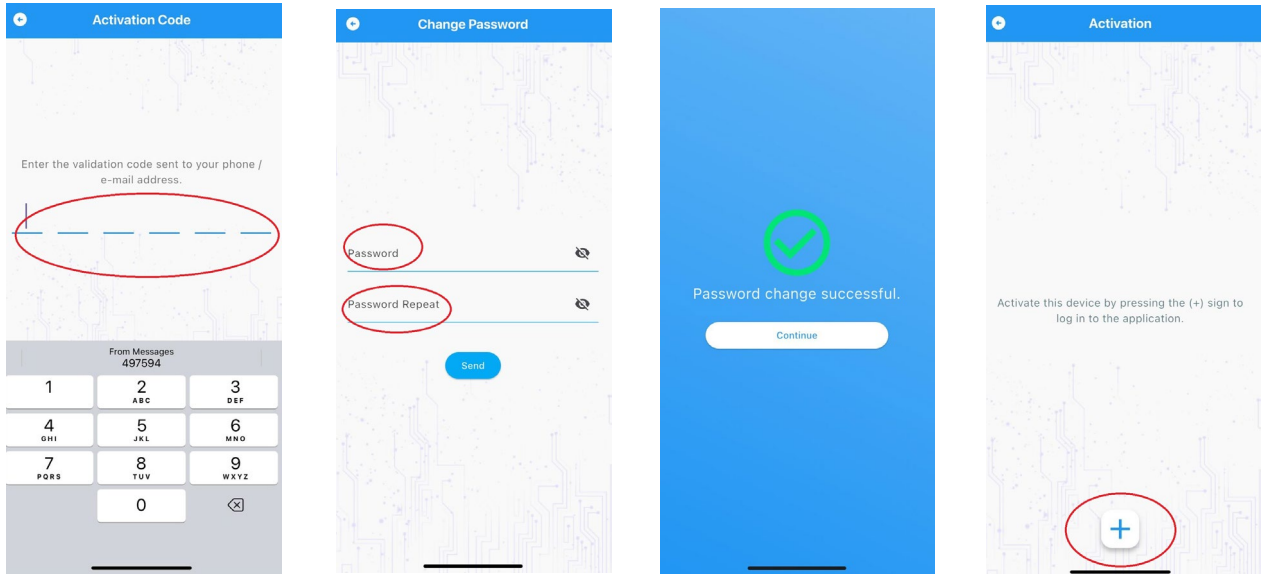

Capture 5

Capture 6

Capture 7

Capture 8

Prepared By	BİLGİ İŞLEM DAİRE BAŞKANLIĞI	Approved By	BİLGİ İŞLEM DAİRE BAŞKANI
Revised By		Revise Reason	

 BAU Bahçeşehir University	BAUPASS INSTALLATION AND USER GUIDE		Page Number	2 / 2
	Document Number	BAU-BİDB-KL-014	Revise Numver	-
BAHÇEŞEHİR UNIVERSITY	Publish Date	12.09.2024	Revise Date	-

BauPass Door Interaction & Device Activation

You can scan the door openings in your BAU Pass profile by pressing the ‘QR’ button. Also, in case of a possible device change, you need to click on the ‘Activation’ option in your BAU Pass profile and then click on the ‘X’ sign on the right side of the screen.

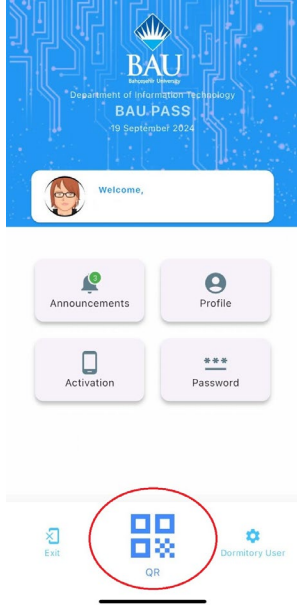

Capture 9

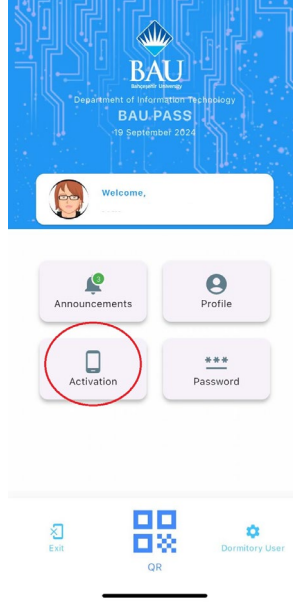

Capture 10

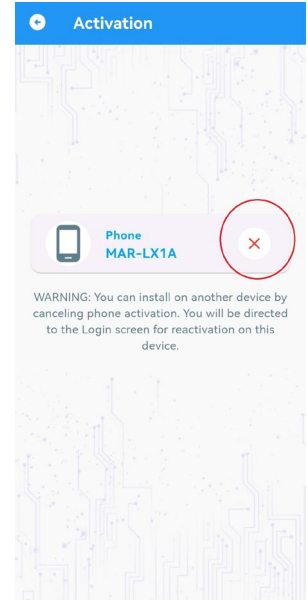

Capture 11

Prepared By	BİLGİ İŞLEM DAİRE BAŞKANLIĞI	Approved By	BİLGİ İŞLEM DAİRE BAŞKANI
Revised By		Revise Reason	